

### Product Description

The Double Tied Lateral expansion joints are there to absorb large amounts of lateral movement in any direction.

These are generally used where there is expansion and a change in the direction of the pipework.

### Design Features

- Max working pressure of 10 Bar
- Maximum design temperature of 300°C
- 316 Stainless Steel Membranes
- 304 Stainless Steel flow sleeves
- Carbon Steel Tie Bars, nuts and washers
- Carbon Steel Pipe & Flanges

Available in the following nominal size:

- 50mm to 300mm

## Double Tied Lateral Expansion Joint Data Sheet

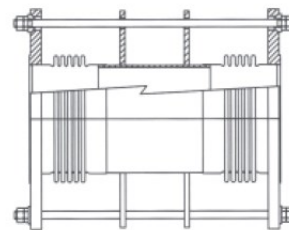
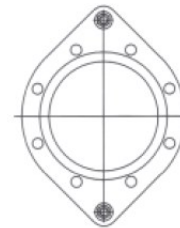

Nominal Bore		Part Number	Lateral Movement (+/-) mm	Overall Length	
(mm)	"			Flanged	Welded End
50	2	MTS-DTLEJ-050	50	500	650
65	2 1/2	MTS-DTLEJ-065	50	500	650
80	3	MTS-DTLEJ-080	50	500	650
100	4	MTS-DTLEJ-100	50	500	650
125	5	MTS-DTLEJ-125	50	650	800
150	6	MTS-DTLEJ-150	50	650	800
200	8	MTS-DTLEJ-200	50	700	850
250	10	MTS-DTLEJ-250	50	700	850
300	12	MTS-DTLEJ-300	50	700	850